

APPENDIX A

Applicants name	Tops Pizza Limited
Name and address of premises	Tops Pizza 85 Waterhouse Street Hemel Hempstead Hertfordshire HP1 1ED
Ward	Hemel Hempstead Town

1. **Current Licence**

- 1.1 The premises is not currently subject to authorisation under the Licensing Act 2003.

2. **Application**

- 2.1 An application has been made for the grant of a new premises licence under section 17 of the Licensing Act 2003. This is set out at Annex A.

- 2.2 Authorisation is sought for the following licensable activity:

Provision of late night refreshment (both indoors and outdoors)
Monday to Sunday 23:00 hours to 01:00 hours

Hours the premises may open to the public
Monday to Sunday 11:30 hours to 01:00 hours

- 2.3 A plan of the premises and map of the area are set out at Annexes B1-B2.

3. **Details of Representation**

- 3.1 One representation has been received from a person living within the vicinity of the premises, which cites concerns in respect of public nuisance. This representation is set out at Annex C.

- 3.2 The following responses were received from responsible authority officers in respect of the application:

Police – no relevant representations
Fire Officer – no relevant representations

4. **Observations**

- 4.1 Relevant extracts from the Council's Statement of Licensing Policy and the statutory guidance are set out at Annex D.

Annex A – Application for grant of premises licence



Dacorum
Application for a premises licence
Licensing Act 2003

For help contact
licensing@dacorum.gov.uk
Telephone: 01442 228000

* required information

Section 1 of 19	
You can save the form at any time and resume it later. You do not need to be logged in when you resume.	
System reference	<input type="text" value="Not Currently In Use"/> This is the unique reference for this application generated by the system.
Your reference	<input type="text"/> You can put what you want here to help you track applications if you make lots of them. It is passed to the authority.
Are you an agent acting on behalf of the applicant?	Put "no" if you are applying on your own behalf or on behalf of a business you own or work for.
<input type="radio"/> Yes	<input checked="" type="radio"/> No
Applicant Details	
* First name	<input type="text" value="ALI"/>
* Family name	<input type="text" value="YAZDI"/>
* E-mail	<input type="text" value="ay@topspizza.com"/>
Main telephone number	<input type="text" value="02082262060"/> Include country code.
Other telephone number	<input type="text"/>
<input type="checkbox"/> Indicate here if you would prefer not to be contacted by telephone	
Are you:	
<input checked="" type="radio"/> Applying as a business or organisation, including as a sole trader	A sole trader is a business owned by one person without any special legal structure. Applying as an individual means you are applying so you can be employed, or for some other personal reason, such as following a hobby.
<input type="radio"/> Applying as an individual	
Applicant Business	
Is your business registered in the UK with Companies House?	<input checked="" type="radio"/> Yes <input type="radio"/> No Note: completing the Applicant Business section is optional in this form.
Registration number	<input type="text" value="02229782"/>
Business name	<input type="text" value="Tops Pizza LTD"/> If your business is registered, use its registered name.
VAT number	<input type="text" value="-"/> <input type="text" value="495 414 719"/> Put "none" if you are not registered for VAT.
Legal status	<input type="text" value="Private Limited Company"/>

Continued from previous page...

Your position in the business

Home country

The country where the headquarters of your business is located.

Registered Address

Address registered with Companies House.

Building number or name

Street

District

City or town

County or administrative area

Postcode

Country

Section 2 of 19

PREMISES DETAILS

I/we, as named in section 1, apply for a premises licence under section 17 of the Licensing Act 2003 for the premises described in section 2 below (the premises) and I/we are making this application to you as the relevant licensing authority in accordance with section 12 of the Licensing Act 2003.

Premises Address

Are you able to provide a postal address, OS map reference or description of the premises?

- Address OS map reference Description

Postal Address Of Premises

Building number or name

Street

District

City or town

County or administrative area

Postcode

Country

Further Details

Telephone number

Non-domestic rateable value of premises (£)

Section 3 of 19

APPLICATION DETAILS

In what capacity are you applying for the premises licence?

- An individual or individuals
- A limited company
- A partnership
- An unincorporated association
- A recognised club
- A charity
- The proprietor of an educational establishment
- A health service body
- A person who is registered under part 2 of the Care Standards Act 2000 (c14) in respect of an independent hospital in Wales
- A person who is registered under Chapter 2 of Part 1 of the Health and Social Care Act 2008 in respect of the carrying on of a regulated activity (within the meaning of that Part) in an independent hospital in England
- The chief officer of police of a police force in England and Wales
- Other (for example a statutory corporation)

Confirm The Following

- I am carrying on or proposing to carry on a business which involves the use of the premises for licensable activities
- I am making the application pursuant to a statutory function
- I am making the application pursuant to a function discharged by virtue of Her Majesty's prerogative

Section 4 of 19

NON INDIVIDUAL APPLICANTS

Provide name and registered address of applicant in full. Where appropriate give any registered number. In the case of a partnership or other joint venture (other than a body corporate), give the name and address of each party concerned.

Non Individual Applicant's Name

Name

Details

Registered number (where applicable)

Description of applicant (for example partnership, company, unincorporated association etc)

Continued from previous page...

company

Address

Building number or name

Street

District

City or town

County or administrative area

Postcode

Country

Contact Details

E-mail

Telephone number

Other telephone number

Section 5 of 19

OPERATING SCHEDULE

When do you want the premises licence to start? / /
dd mm yyyy

If you wish the licence to be valid only for a limited period, when do you want it to end / /
dd mm yyyy

Provide a general description of the premises

For example the type of premises, its general situation and layout and any other information which could be relevant to the licensing objectives. Where your application includes off-supplies of alcohol and you intend to provide a place for consumption of these off-supplies you must include a description of where the place will be and its proximity to the premises.

The premises known as 85 Waterhouse street, Hemel Hempstead, HP1 1ED is registered for A3 or A5 use with the Hemel Hempstead county council. We have transformed the shop premises to a pizza delivery store and would like to obtain the right to late night refreshments.

If 5,000 or more people are expected to attend the premises at any one time, state the number expected to attend

<i>Continued from previous page...</i>
Section 6 of 19
PROVISION OF PLAYS
Will you be providing plays?
<input type="radio"/> Yes <input checked="" type="radio"/> No
Section 7 of 19
PROVISION OF FILMS
Will you be providing films?
<input type="radio"/> Yes <input checked="" type="radio"/> No
Section 8 of 19
PROVISION OF INDOOR SPORTING EVENTS
Will you be providing indoor sporting events?
<input type="radio"/> Yes <input checked="" type="radio"/> No
Section 9 of 19
PROVISION OF BOXING OR WRESTLING ENTERTAINMENTS
Will you be providing boxing or wrestling entertainments?
<input type="radio"/> Yes <input checked="" type="radio"/> No
Section 10 of 19
PROVISION OF LIVE MUSIC
Will you be providing live music?
<input type="radio"/> Yes <input checked="" type="radio"/> No
Section 11 of 19
PROVISION OF RECORDED MUSIC
Will you be providing recorded music?
<input type="radio"/> Yes <input checked="" type="radio"/> No
Section 12 of 19
PROVISION OF PERFORMANCES OF DANCE
Will you be providing performances of dance?
<input type="radio"/> Yes <input checked="" type="radio"/> No
Section 13 of 19
PROVISION OF ANYTHING OF A SIMILAR DESCRIPTION TO LIVE MUSIC, RECORDED MUSIC OR PERFORMANCES OF DANCE
Will you be providing anything similar to live music, recorded music or performances of dance?
<input type="radio"/> Yes <input checked="" type="radio"/> No
Section 14 of 19
LATE NIGHT REFRESHMENT
Will you be providing late night refreshment?

Continued from previous page...

Yes

No

Standard Days And Timings

MONDAY

Start

End

Give timings in 24 hour clock.
(e.g., 16:00) and only give details for the days
of the week when you intend the premises
to be used for the activity.

Start

End

TUESDAY

Start

End

Start

End

WEDNESDAY

Start

End

Start

End

THURSDAY

Start

End

Start

End

FRIDAY

Start

End

Start

End

SATURDAY

Start

End

Start

End

SUNDAY

Start

End

Start

End

Will the provision of late night refreshment take place indoors or outdoors or both?

Indoors

Outdoors

Both

Where taking place in a building or other structure tick as appropriate. Indoors may include a tent.

State type of activity to be authorised, if not already stated, and give relevant further details, for example (but not exclusively) whether or not music will be amplified or unamplified.

The selling and delivering hot food and takeaway.

State any seasonal variations

Continued from previous page...

For example (but not exclusively) where the activity will occur on additional days during the summer months.

No seasonal variation.

Non-standard timings. Where the premises will be used for the supply of late night refreshments at different times from those listed in the column on the left, list below

For example (but not exclusively), where you wish the activity to go on longer on a particular day e.g. Christmas Eve.

No

Section 15 of 19

SUPPLY OF ALCOHOL

Will you be selling or supplying alcohol?

- Yes No

PROPOSED DESIGNATED PREMISES SUPERVISOR CONSENT

How will the consent form of the proposed designated premises supervisor be supplied to the authority?

- Electronically, by the proposed designated premises supervisor
 As an attachment to this application

Reference number for consent form (if known)

If the consent form is already submitted, ask the proposed designated premises supervisor for its 'system reference' or 'your reference'.

Section 16 of 19

ADULT ENTERTAINMENT

Highlight any adult entertainment or services, activities, or other entertainment or matters ancillary to the use of the premises that may give rise to concern in respect of children

Give information about anything intended to occur at the premises or ancillary to the use of the premises which may give rise to concern in respect of children, regardless of whether you intend children to have access to the premises, for example (but not exclusively) nudity or semi-nudity, films for restricted age groups etc gambling machines etc.

NONE

Section 17 of 19

HOURS PREMISES ARE OPEN TO THE PUBLIC

Standard Days And Timings

Continued from previous page...

MONDAY

Start

End

Give timings in 24 hour clock.
(e.g., 16:00) and only give details for the days
of the week when you intend the premises
to be used for the activity.

Start

End

TUESDAY

Start

End

Start

End

WEDNESDAY

Start

End

Start

End

THURSDAY

Start

End

Start

End

FRIDAY

Start

End

Start

End

SATURDAY

Start

End

Start

End

SUNDAY

Start

End

Start

End

State any seasonal variations

For example (but not exclusively) where the activity will occur on additional days during the summer months.

NONE

Non standard timings. Where you intend to use the premises to be open to the members and guests at different times from those listed in the column on the left, list below

For example (but not exclusively), where you wish the activity to go on longer on a particular day e.g. Christmas Eve.

NONE

Continued from previous page...

Section 18 of 19

LICENSING OBJECTIVES

Describe the steps you intend to take to promote the four licensing objectives:

a) General – all four licensing objectives (b,c,d,e)

List here steps you will take to promote all four licensing objectives together.

Health and safety at work, Allergy awareness, hazard analysis, food safety management and fire prevention.

b) The prevention of crime and disorder

The required standard of CCTV camera is in operation on 24 hours bases, door are fitted with secure quality mortise locks. All incidents are registered and reported to the police and CCTV camera footage are kept for future evidence and presented on request. All emergency contact details such as local police, hospital, fire brigade and other related local authorities are kept on hand in the premises and staff are trained to contact the related department on emergency cases.

c) Public safety

Portable fire equipments and first aid equipments are provided and stored in easy accessible places where also stickers are displayed to indicate their location. All members of staff are trained how to use the fire and first aid equipments in case of emergency. Public liability insurance is obtained for the business and premises. Signs for fire exit and CCTV camera are displayed inside the premises for the public awareness.

d) The prevention of public nuisance

Premises are adequately ventilated and our team members are trained to frequently monitor the vicinity of our store and premises and clear disposed rubbish and waste created by our customers, in particular empty bottles and cans. Also our staffs are required to report to the store manager or shift manager about incidents acquired or any potential anti social behavior or aggressive attitude that could possibly cause nuisance or distraction to the neighborhood members of the public. Our employees are fully trained in how to defuse and calm any potential anti social behavior using their professional skills and friendly attitude.

e) The protection of children from harm

Our members of staff are fully trained and experienced in how to prevent overcrowding and nuisance inside the store, especially during the weekends and rush hours when a large number of young people and youths may come order food, in such circumstances it is highly likely that the children and youngsters have disputes over their food and orders to prevent this from happening we employ additional staff to allow us to be able to serve our customers as quickly and efficiently as possible, so to be able us to observe the safety of the young children by identifying possible hazards such as aggressive behavior towards children, bullying and harassment. Also all our team members are required to report any aggressive behavior towards children and young people directly to the manager and the police.

Section 19 of 19

PAYMENT DETAILS

This fee must be paid to the authority. If you complete the application online, you must pay it by debit or credit card.

Premises licence application fees are determined by the non-domestic rateable value of the premises. You can find out the current rateable value of your premises using the Valuation Office Agency's search engine at:

<http://www.2010.voa.gov.uk/rli/>

Band A | Premises not rated, or rateable value up to £4,300

Application fee: £100.00

Band B | Rateable value between £4,301 and £33,000

Application fee: £190.00

Continued from previous page...

Band C | Rateable value between £33,001 to £87,000

Application fee: £315.00

Band D | Rateable value between £87,001 to £125,000

Application fee: £450.00 #

Band E | Rateable value £125,001 or greater

Application fee: £635.00 #

Premises in bands D or E used primarily for the consumption of alcohol on the premises are subject to fee multipliers, requiring fees of £900.00 or £1,905.00 respectively. Premises undergoing construction or redevelopment are treated as if they were in Band C for fee purposes.

Certain community premises, including church halls, chapel halls, village halls, community centres and schools and colleges, which are only licensed for entertainment and NOT alcohol or late night refreshment, may be exempt from licensing application and annual fees. Please contact us to discuss whether your premises will fall within this exemption.

Premises licences for large capacity events (i.e. more than 5,000 people attending) will require payment of an additional fee, based upon the number of people permitted to attend the event at any time. Please contact us for details of these additional fees.

* Fee amount (£)

190.00

DECLARATION

* I/we understand it is an offence, liable on conviction to a fine up to level 5 on the standard scale, under section 158 of the Licensing Act 2003, to make a false statement in or in connection with this application.

I understand that I must now advertise my application, by arranging for a public notice to be published in a local

* newspaper within the next 10 working days, and by displaying notices printed on blue paper at or near the premises and conveniently readable at all times for the next 28 days.

Ticking this box indicates you have read and understood the above declaration

This section should be completed by the applicant, unless you answered "Yes" to the question "Are you an agent acting on behalf of the applicant?"

* Full name

ALI YAZDI

* Capacity

DIRECTOR

* Date

31 / 01 / 2017
dd mm yyyy

Add another signatory

Once you're finished you need to do the following:

1. Save this form to your computer by clicking file/save as...

2. Go back to <https://www.gov.uk/apply-for-a-licence/premises-licence/dacorum/apply-1> to upload this file and continue with your application.

Don't forget to make sure you have all your supporting documentation to hand.

IT IS AN OFFENCE, LIABLE ON SUMMARY CONVICTION TO A FINE NOT EXCEEDING LEVEL 5 ON THE STANDARD SCALE, UNDER SECTION 158 OF THE LICENSING ACT 2003, TO MAKE A FALSE STATEMENT IN OR IN CONNECTION WITH THIS APPLICATION

Annex B1: Plan of premises

85 Waterhouse Street, HP1 1ED

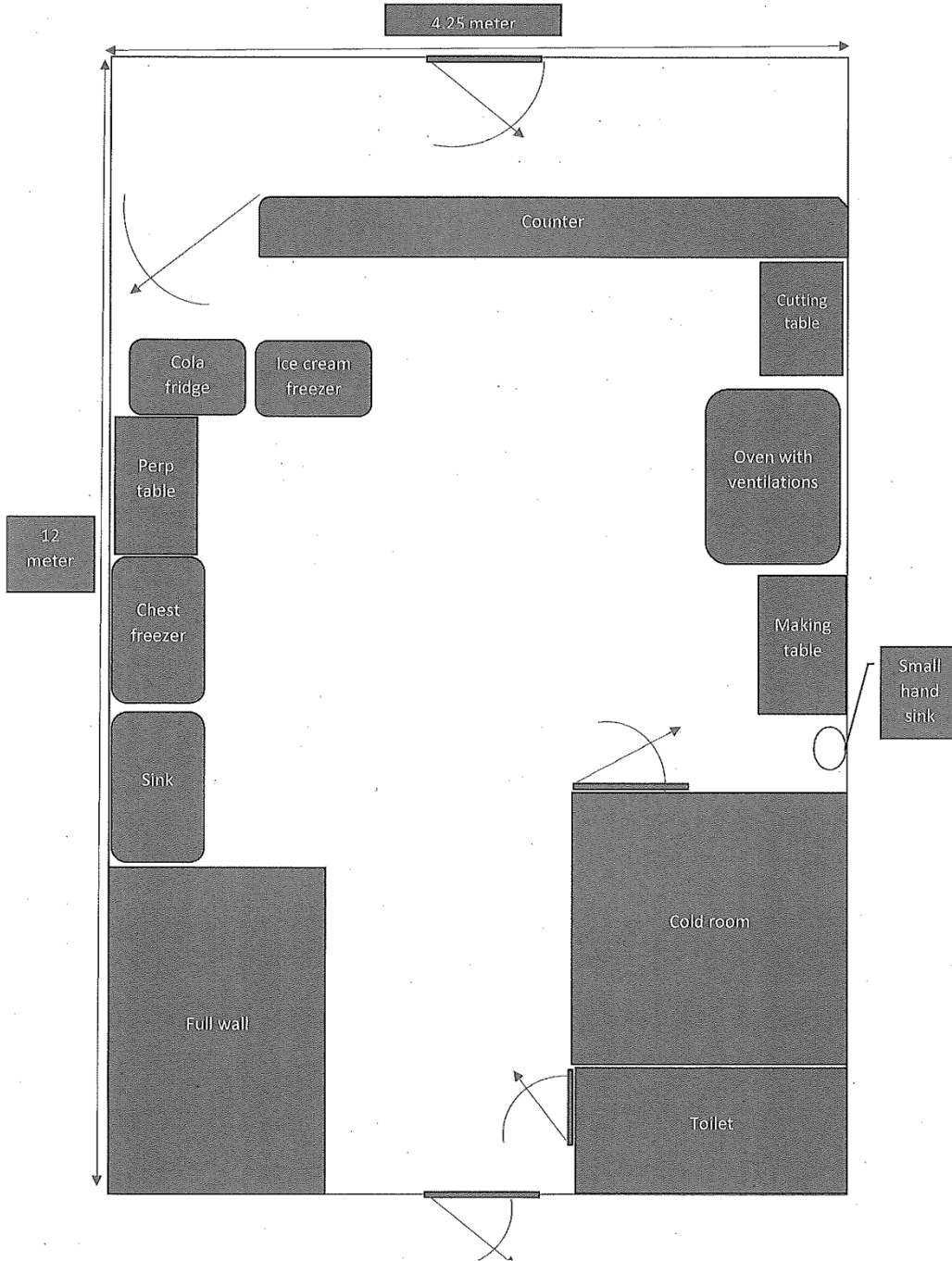

Annex B2 – Map of Area

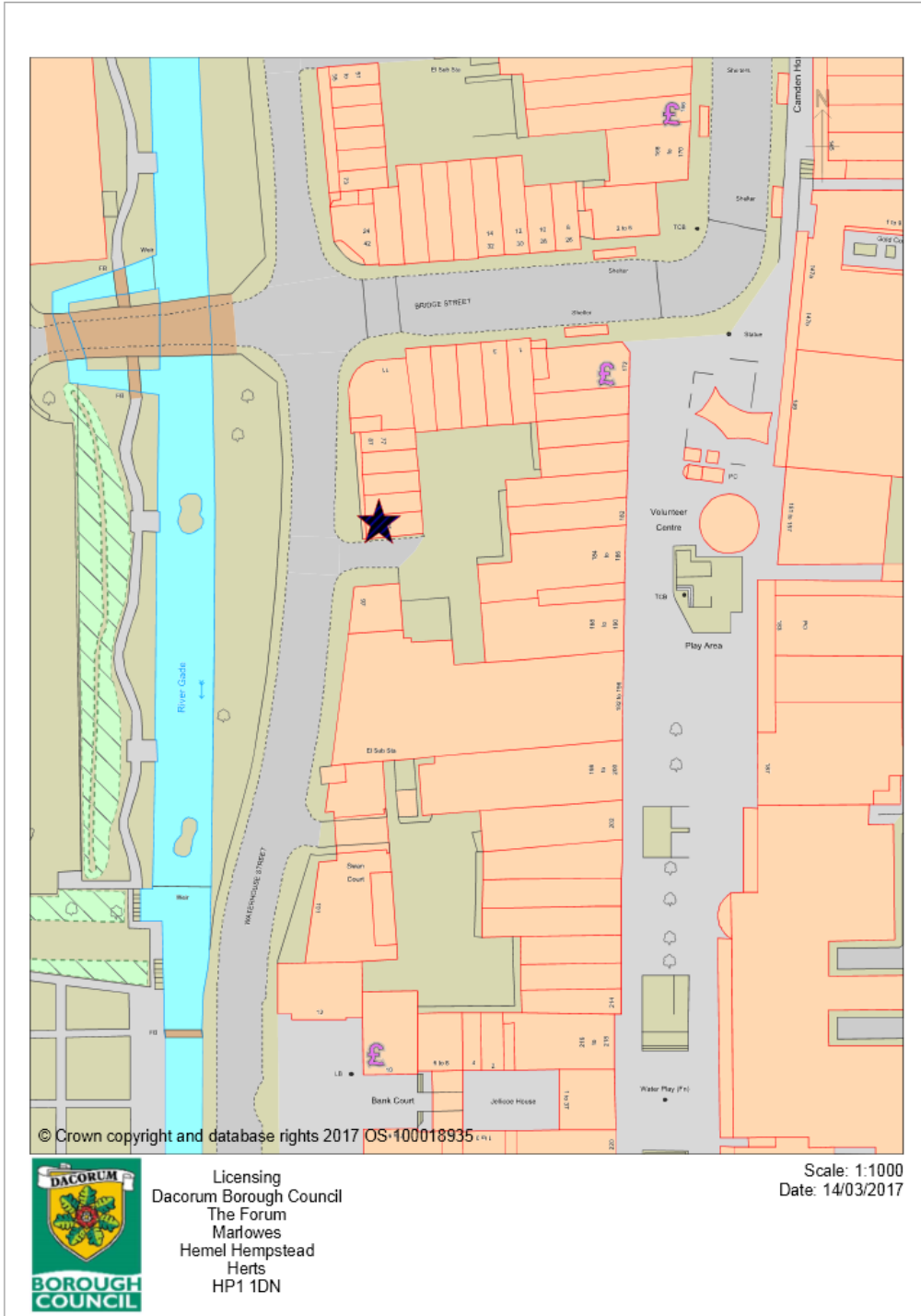

Annex C – Representation

From:

Sent: 01 March 2017 22:11

To: Sally Mcdonald

Subject: Re: Premises licence application - Tops Pizza 85 Waterhouse Street Hemel Hempstead

Good evening,

Thank you for your reply.

I am not sure how to better explain, but no doubt, by allowing another business to operate so late at night, it will increase footfall and the number of people visiting the area, hence more noise, rubbish and incidents.

The additional vehicles will produce additional noise, and exacerbate parking issues in the area. We already had to complain to the car park management because of lack of parking for residents, as there is nowhere else for us to park apart from the paid car park. There has already been a barrier put there for this reason. Do they say how many more vehicles they will be bringing in? There's already so many takeaway delivery vehicles there. They already park illegally on the street.

Based on all of the above reasons, the licensing objective of preventing public nuisance is not met. I do believe that me and my family deserve a good night sleep, and not be constantly disturbed by people shouting and arguing, traffic congestion and noise pollution. As previously mentioned, after the taxi rank was introduced, the number of police callouts dealing with public disorder increased significantly, and although the police is called, it is still a real issue. By having another takeaway with more delivery drivers and more customers visiting this premises late at night, this will just become a more regular occurrence.

Kind regards,

Annex D

Local Policy considerations and statutory guidance

Local Policy

Public Nuisance

5.12. The licensing authority will interpret the term 'public nuisance' widely, and when considering this objective will take into account issues relating to noise, vibration, light, litter, offensive odours and anti-social behaviour arising from or in connection with the provision of licensable activities.

Applications

9.1. Every matter requiring determination by the licensing authority will be considered on its individual merits, and in doing so the authority shall have regard to this Statement, the Guidance, and the need to promote the licensing objectives. Where applicable, an evidentiary hearing will be conducted prior to the determination of the matter, in full accordance with Regulations made under the Act.

9.3. Where the authority's discretion is engaged, following receipt of a relevant representation or an objection notice, or in the case of review or minor variation applications, the licensing authority will apply the considerations set out below.

9.4. Almost all of the decision-making powers under the Act require licensing authorities to take such action as they consider appropriate for the promotion of the licensing objectives. The Act was amended to substitute 'appropriate' for 'necessary', a move which may be regarded as having increased authorities discretion in respect of the determination of applications. The licensing authority will now consider 'appropriate' in accordance with the standard dictionary definition: "suitable or proper in the circumstances".

9.6. When considering applications for a new licence, or a variation of an existing licence, the options available to the authority will generally include: granting the application as applied for, granting the application with amendments to the operating schedule or additional conditions, or refusing the application. The last of these options is clearly the most serious, and the authority will only look to refuse applications where it is satisfied that the proposed activities could not be carried on, even with modifications or additional restrictions, without a detrimental effect to the licensing objectives.

Licensing hours

10.3. Licensing hours should not inhibit the development of a thriving and safe evening and night time economy. This is important for investment, local employment, tourism and local services associated with the night time economy. Providing consumers with greater choice and flexibility is an important consideration, but should always be balanced carefully against the duty to promote the licensing objectives and the interests of local residents.

10.4. The licensing authority expects that issues relating to licensing hours, and in particular measures to limit the potential for nuisance or disorder arising from later hours of trading, will be addressed by the applicant in their operating schedule.

10.5. In addition to their licensable activities, applicants are also expected to set out the proposed opening hours of their premises within their operating schedule. The licensing authority expects these times to be provided for all premises which may be

accessed by members of the public, as these will inform the authority, responsible authorities and other persons of the full extent of the operation of the premises, and allow all parties to consider the application and the effect on the licensing objectives fully. The hours given should include all times when the premises may trade to the public (whether licensable activities are being provided or not), when individuals may be present on the premises.

10.8. The licensing authority will deal with the issue of licensing hours on the individual merits of each application. However, when issuing a licence, stricter conditions are more likely to be considered appropriate for the promotion of the public nuisance objective in the case of premises that are situated in predominantly residential areas.

Licence Conditions

11.1. The licensing authority will seek to avoid imposing disproportionate conditions on premises. It will only impose conditions that it considers appropriate in order to promote the licensing objectives, and which are in themselves reasonable and proportionate.

11.2. Additionally, we will seek to ensure that conditions only pertain to matters which are within the direct control or the sphere of influence of the licence-holder.

National Guidance

Each application on its own merits

1.17. Each application must be considered on its own merits and in accordance with the licensing authority's statement of licensing policy; for example, if the application falls within the scope of a cumulative impact policy. Conditions attached to licences and certificates must be tailored to the individual type, location and characteristics of the premises and events concerned. This is essential to avoid the imposition of disproportionate and overly burdensome conditions on premises where there is no need for such conditions. Standardised conditions should be avoided and indeed may be unlawful where they cannot be shown to be appropriate for the promotion of the licensing objectives in an individual case.

Public Nuisance

2.14. The 2003 Act enables licensing authorities and responsible authorities, through representations, to consider what constitutes public nuisance and what is appropriate to prevent it in terms of conditions attached to specific premises licences and club premises certificates. It is therefore important that in considering the promotion of this licensing objective, licensing authorities and responsible authorities focus on the effect of the licensable activities at the specific premises on persons living and working (including those carrying on business) in the area around the premises which may be disproportionate and unreasonable. The issues will mainly concern noise nuisance, light pollution, noxious smells and litter.

2.18 Where applications have given rise to representations, any appropriate conditions should normally focus on the most sensitive periods. In certain circumstances, conditions relating to noise emanating from the premises may also be appropriate to address any disturbance anticipated as customers enter and leave.

2.20 Beyond the immediate area surrounding the premises, these are matters for the personal responsibility of individuals under the law. An individual who engages in anti-social behaviour is accountable in their own right. However, it would be perfectly

reasonable for a licensing authority to impose a condition, following relevant representations, that requires the licence holder or club to place signs at the exits from the building encouraging patrons to be quiet until they leave the area, or that, if they wish to smoke, to do so at designated places on the premises instead of outside, and to respect the rights of people living nearby to a peaceful night.

Determination of applications

9.36 As a matter of practice, licensing authorities should seek to focus the hearing on the steps considered appropriate to promote the particular licensing objective or objectives that have given rise to the specific representation and avoid straying into undisputed areas. A responsible authority or other person may choose to rely on their written representation. They may not add further representations to those disclosed to the applicant prior to the hearing, but they may expand on their existing representation.

9.37 In determining the application with a view to promoting the licensing objectives in the overall interests of the local community, the licensing authority must give appropriate weight to:

- the steps that are appropriate to promote the licensing objectives;
- the representations (including supporting information) presented by all the parties;
- this Guidance;
- its own statement of licensing policy.

9.38 The licensing authority should give its decision within five working days of the conclusion of the hearing (or immediately in certain specified cases) and provide reasons to support it. This will be important if there is an appeal by any of the parties. Notification of a decision must be accompanied by information on the right of the party to appeal. After considering all the relevant issues, the licensing authority may grant the application subject to such conditions that are consistent with the operating schedule. Any conditions imposed must be appropriate for the promotion of the licensing objectives; there is no power for the licensing authority to attach a condition that is merely aspirational.

Imposed conditions

10.8 The licensing authority may not impose any conditions unless its discretion has been exercised following receipt of relevant representations and it is satisfied as a result of a hearing (unless all parties agree a hearing is not necessary) that it is appropriate to impose conditions to promote one or more of the four licensing objectives.

10.9 It is possible that in some cases no additional conditions will be appropriate to promote the licensing objectives.