

**Item 5a**

**4/00029/16/MFA - DEMOLITION OF ALL EXISTING BUILDINGS.  
CONSTRUCTION OF 32 RESIDENTIAL DWELLINGS, ALTERATIONS TO THE  
EXISTING VEHICULAR ACCESS ONTO AYLESBURY ROAD, LANDSCAPING  
AND THE INTRODUCTION OF INFORMAL PUBLIC OPEN SPACE.**

**CONVENT OF ST FRANCIS DE SALES PREPARATORY SCHOOL, AYLESBURY  
ROAD, TRING, HP23 4DL**

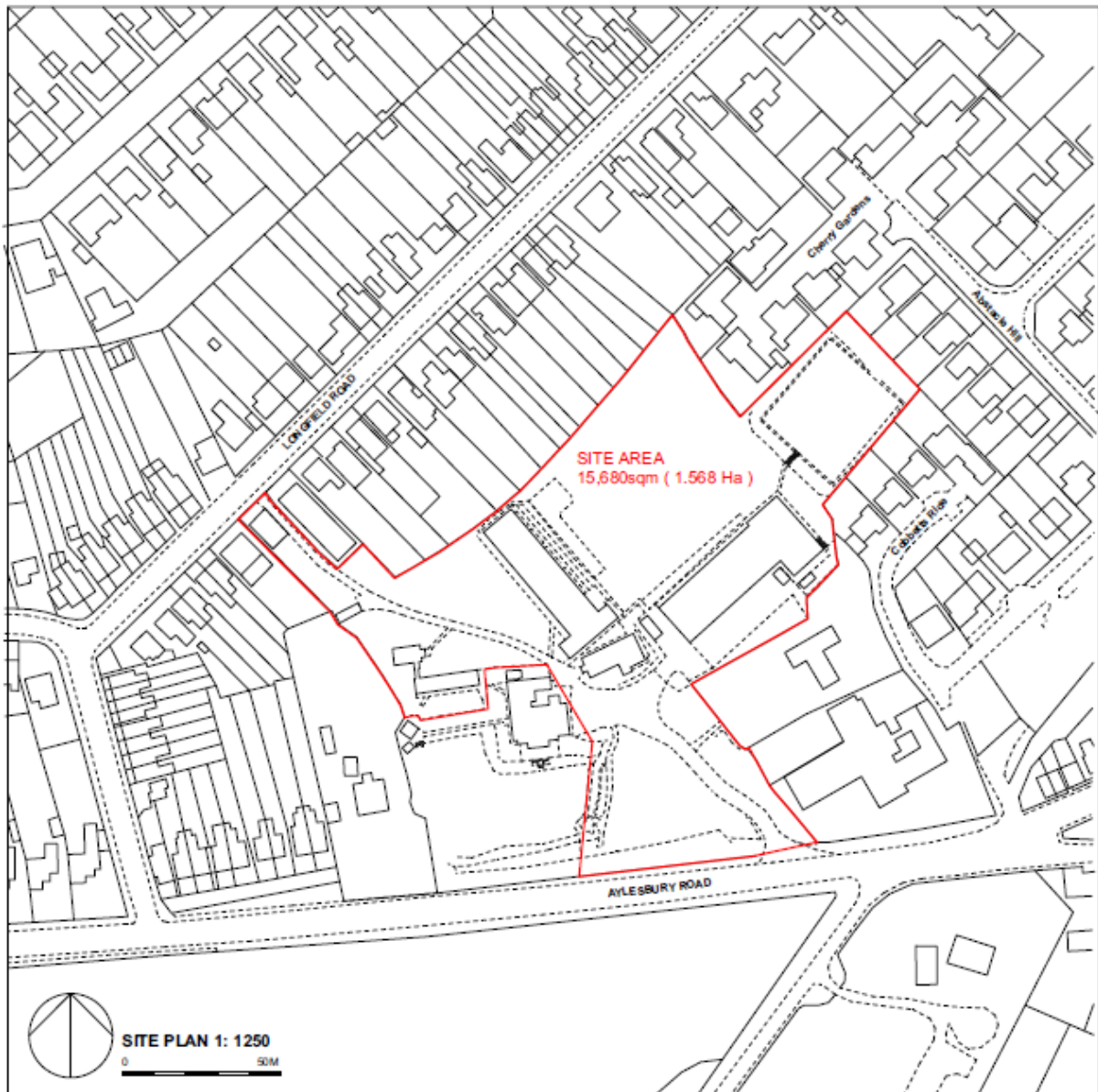

Item 5a

**4/00029/16/MFA - DEMOLITION OF ALL EXISTING BUILDINGS.  
CONSTRUCTION OF 32 RESIDENTIAL DWELLINGS, ALTERATIONS TO THE  
EXISTING VEHICULAR ACCESS ONTO AYLESBURY ROAD, LANDSCAPING  
AND THE INTRODUCTION OF INFORMAL PUBLIC OPEN SPACE.**

**CONVENT OF ST FRANCIS DE SALES PREPARATORY SCHOOL, AYLESBURY  
ROAD, TRING, HP23 4DL**

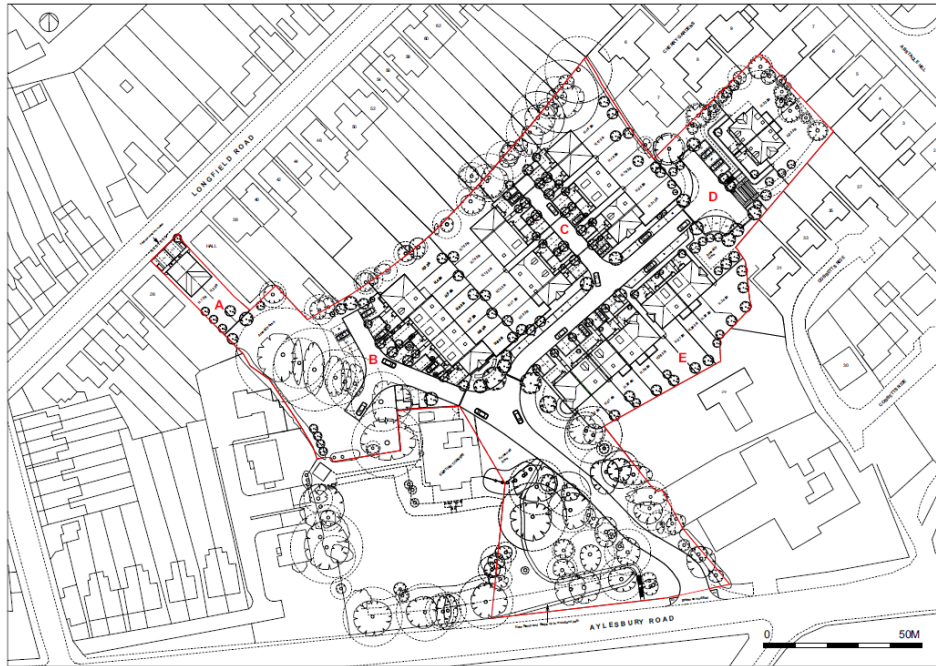

Zone B Elevations H.3 - H.9 / Zone E Flank Elevation H.35 / Access Road down to Aylesbury Road



Zone C Flank Elevation H.10 - H.16 / Access / Flank Elevation H.17 - H.23 / down to Zone D H.24 - H.26



Zone D H.24 - H.26 up to Zone E H.27 - H.30 / H.30 - H.35

Planning Issue 21.12.15

PL12



FRONT ELEVATION To Longfield Road ( NW ) : PROPOSED